

we care 

primus

laundry equipment

Industrial Dryers

DA 11, DA 13, DA 13/13 DA 15



DA 13/13

FEATURES

- Easy to use electronic programmer
- Electronic display
- Galvanized drum
- Standard dryness level setting on the electronic programmer
- New larger door opening for easy loading and unloading
- Large lint filter
- Gas, electric and steam heating

OPTIONS

- Stainless steel drum
- Stainless steel front
- OPL or Coin timer



FAST DRYING
CYCLES



EASY OPERATION



SERVICE FRIENDLY

TYPE		DA 11	DA 13	DA 13/13	DA 15
CAPACITY					
Volume drum	l	220	270	2x300	350
Capacity	kg	11	13	2x13	15
Drum diameter	mm	Ø673	Ø673	Ø2x762	Ø762
AIR FLOW					
	l/s	194	194	2x151	222
DRYING AVERAGE					
	l/min.	0,256	0,301		0,38
ENERGY CONSUMPTION					
	kW/kg	1,36	1,39		1,41
MOTOR					
Fan	kW	0,25	0,25	2x0,25	0,25
Drive	kW	0,18	0,18	2x0,18	0,18
PROGRAMMER					
Electronic (EL)		standard	standard	standard	standard
Coin Timer		+	+	+	+
GAS HEATING					
Energy	kW kBTU/h	19,6 64	25,8 73	21,4 73	31,1 90
El. connection		220-240V/1/50HZ Others on demand			
Gas connection	NPT	1/2"			
STEAM HEATING					
Steam high pressure (5,9 bar)	kg/h (kW) kBTU/h	*42 (24,1) * **48,5 (29,3) 82,4	42 (24,1) **48,5 (29,3) 82,4	2x42 (2x24,1) 111***	*47,3 (27) **54,5 (33,2) 92,4
Steam low pressure (1,03 bar)	kg/h (kW) kBTU/h	*28 (17,1) **34 (20,9) 58,3	*28 (17,1) **34 (20,9) 58,3	2x28 (2x17,1) 74***	*31,5 (19,2) **38 (23,5) 65,6
El. connection		220-240V/1/50HZ Others on demand			
Steam connection	NPT	3/4"			
ELECTRICAL HEATING					
Energy	kW	12 9	21 Others on demand	2x21 Others on demand	24 Others on demand
El. connection		380-400V/3/50Hz Others on demand	380-400V/3/50Hz Others on demand	380-400V/3/50Hz Others on demand	380-400V/3/50Hz Others on demand
EXHAUST Ø	mm	152	152	203	203
DIMENSIONS HxWxD					
	mm	1622x711x987	1622x711x1140	1973x800x1089	1622x800x1140
TRANSPORT DATA					
Gross weight					
Cardboard packing	kg	150	175	275	190
Net weight	kg	136	168	245	170
Cardboard packaging HxWxD	mm	1753x762x1041	1753x762x1194	2075x851x1194	1753x851x1194

+ = available * = 2 coils ** = 4 coils *** for each pocket

FRONT DA 11 13 15

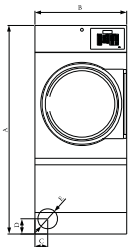

SIDE DA 11 13 15

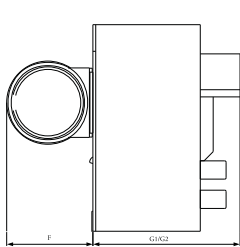

TYPE	DA 11	DA 13	DA 15
A	1622	1622	1622
B	711	711	800
C	99	99	124
D	117	117	143
E	152	152	203
F	667	667	711
G1	987	1140	1140
G2	953	1105	1105

G1 = gas and electrical heating
G2 = steam heating

FRONT DA 13/13

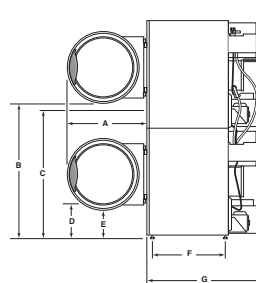

BACK DA 13/13

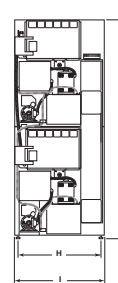

TYPE	DA 13/13
A	711
B	1219
C	1118
D	279
E	254
F	636
G	1086
H	695
I	800
J	1937

The company Primus preserves the right to change the machines and the specification in this leaflet at any time, without prior notice. Details and photographs are only for information and never binding.

www.primuslaundry.com

ISO 9001
ISO 14001
BUREAU VERITAS
Certification

